

PLANTS FIRST

Healthy Plants, Healthy Places CPD, Kew Garden

SARAH PRICE LANDSCAPES

sarahpricelandscapes.com

instagram: [sarahpricelandscapes](https://www.instagram.com/sarahpricelandscapes)











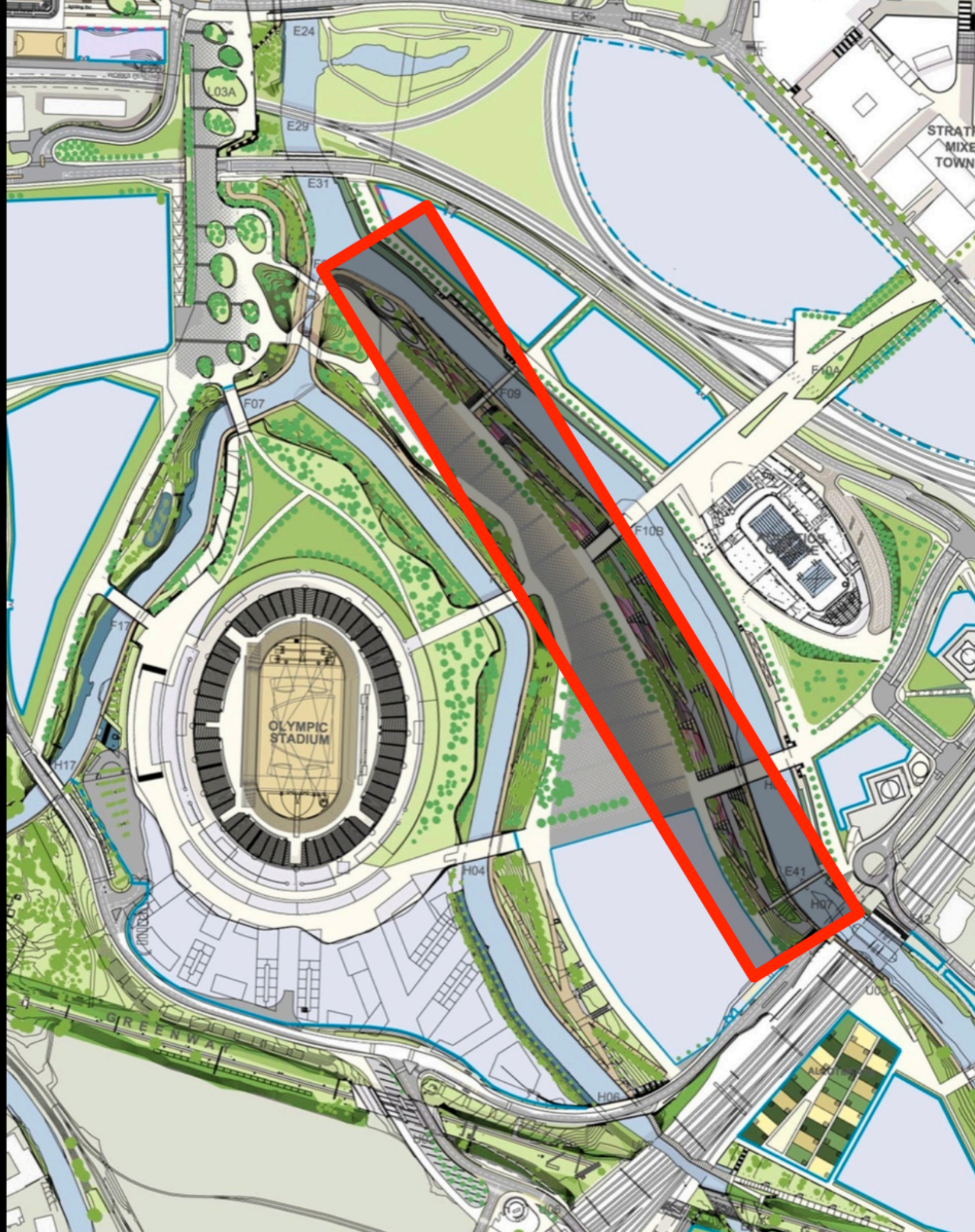

OLYMPIC GARDENS - Plant Families

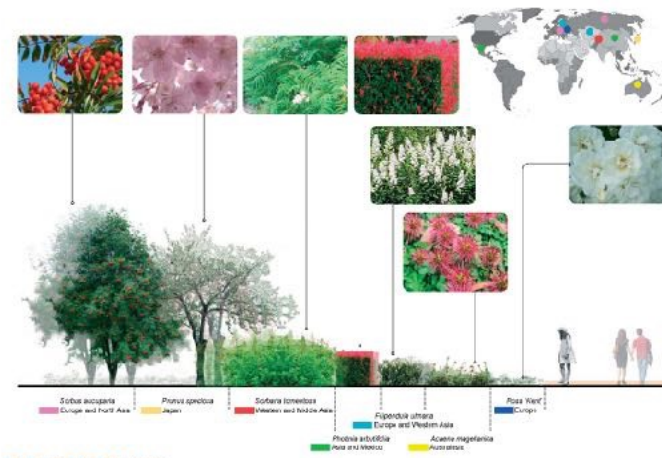

THE ROSE FAMILY

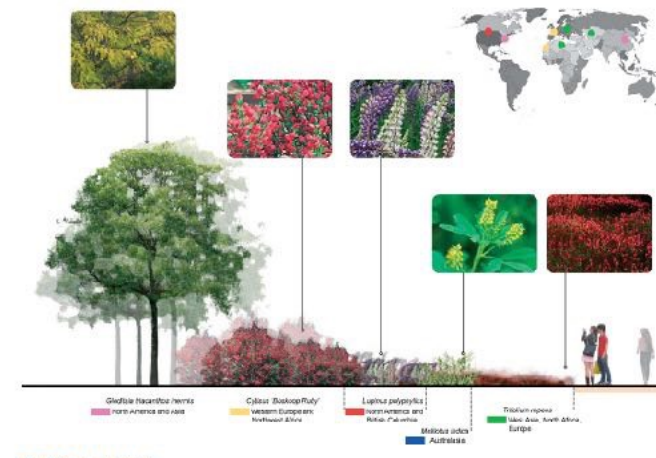

THE PEA FAMILY

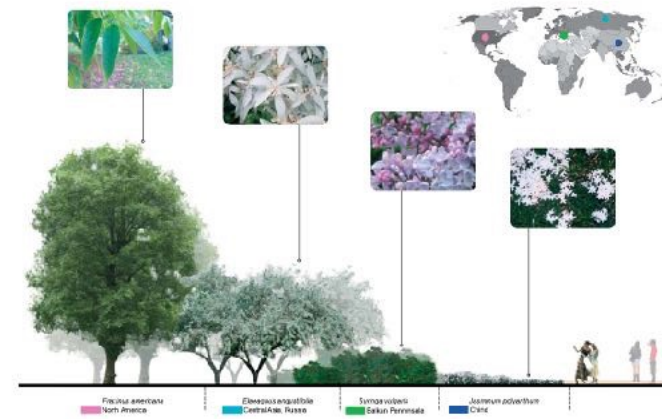

THE OLIVE FAMILY

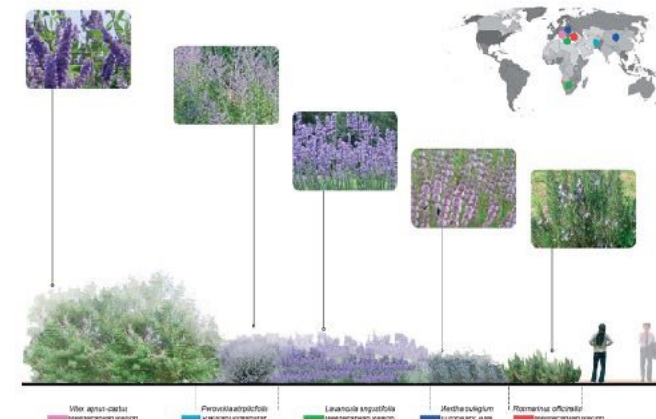

THE MINT FAMILY

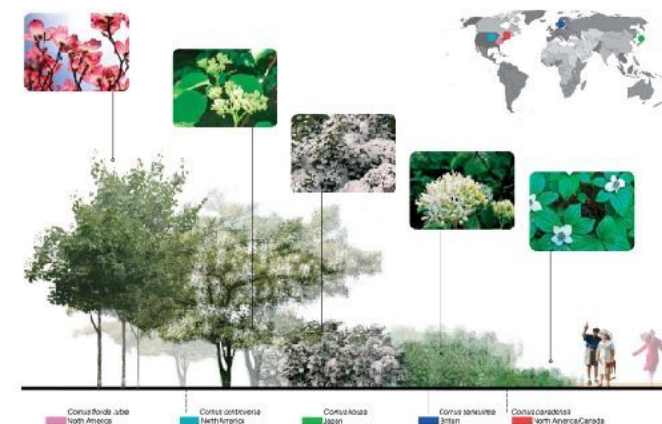

THE DOGWOOD FAMILY

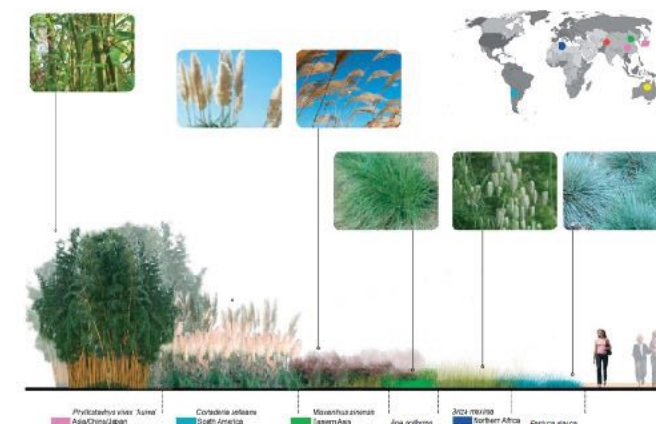

THE GRASSES FAMILY



Example of the way photographs may be recomposed to develop and illustrate design ideas... written word may form part of the visual image. Collage often reveals new possibilities through unexpected juxtapositions. This method is also very useful in clarifying design visions for a scheme.

Phlox tuberosa's dark defined winter structure stands against the white stems of Perovskia 'Blue Spire'.

Consideration shall be given to highlighting plants with dark defined seed heads against lighter backdrops e.g. grasses such as the North American prairie grass Schizachyrium scoparium



Upward spiked forms of clump forming Liatris aspera contrasts with the looser 'filler' species



The large, dark cone-shaped seed heads and flowers of Echinacea species create a long seasonal show - visually arresting punctuations of colour and form when planted in deep bands and drifts.

A Summer Meadow: colourful summer flowers in an abstracted and stylised form of a North American prairie, with peak flowering during late July & August.

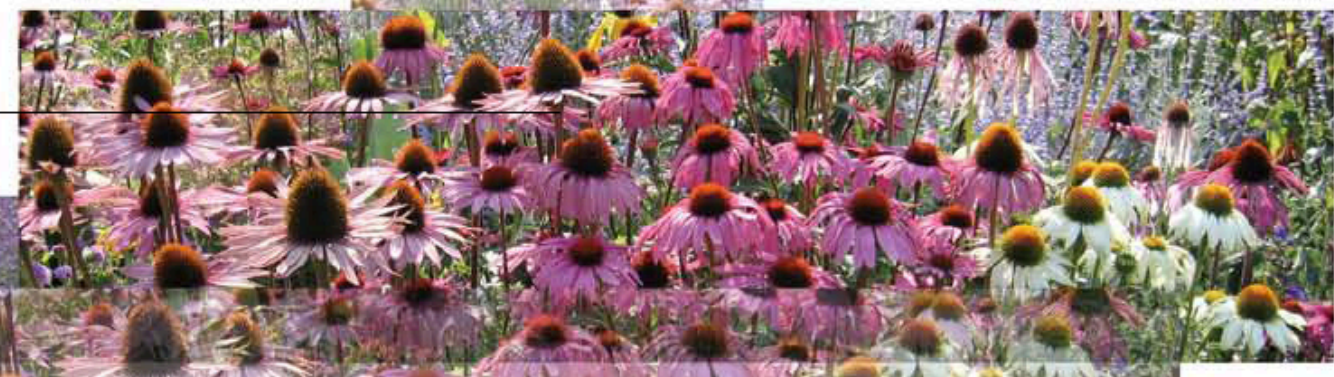
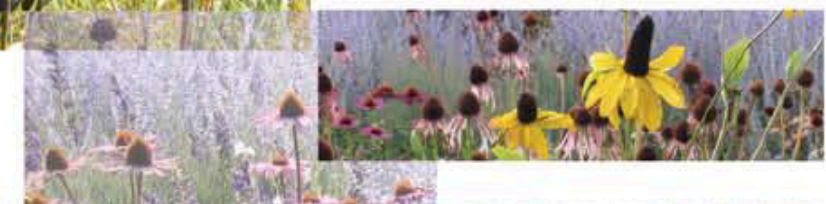

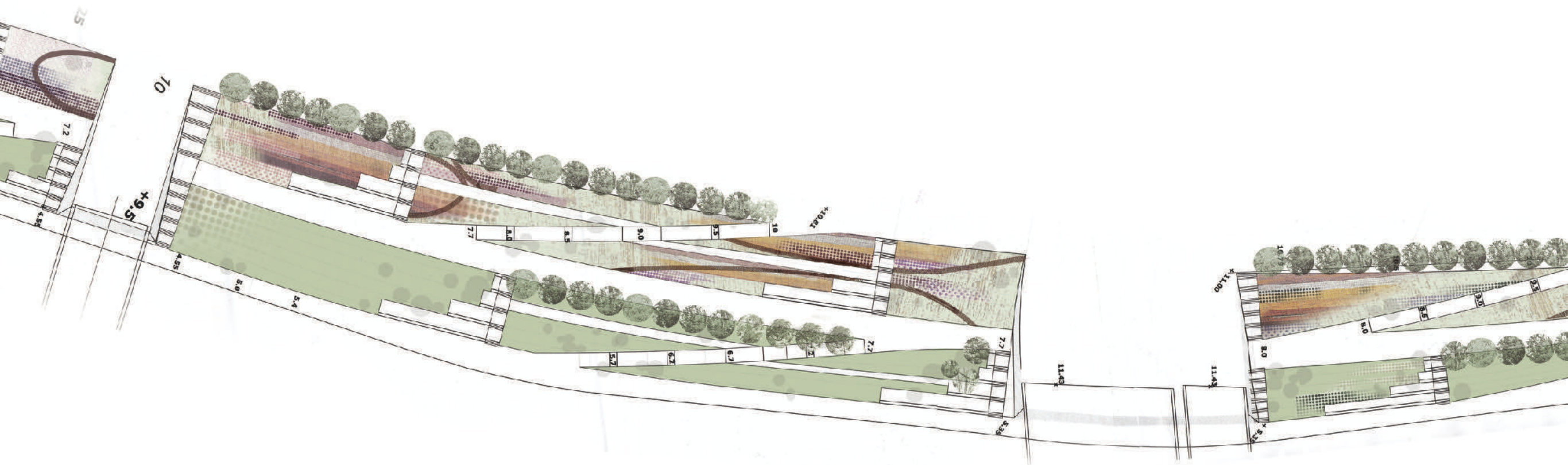

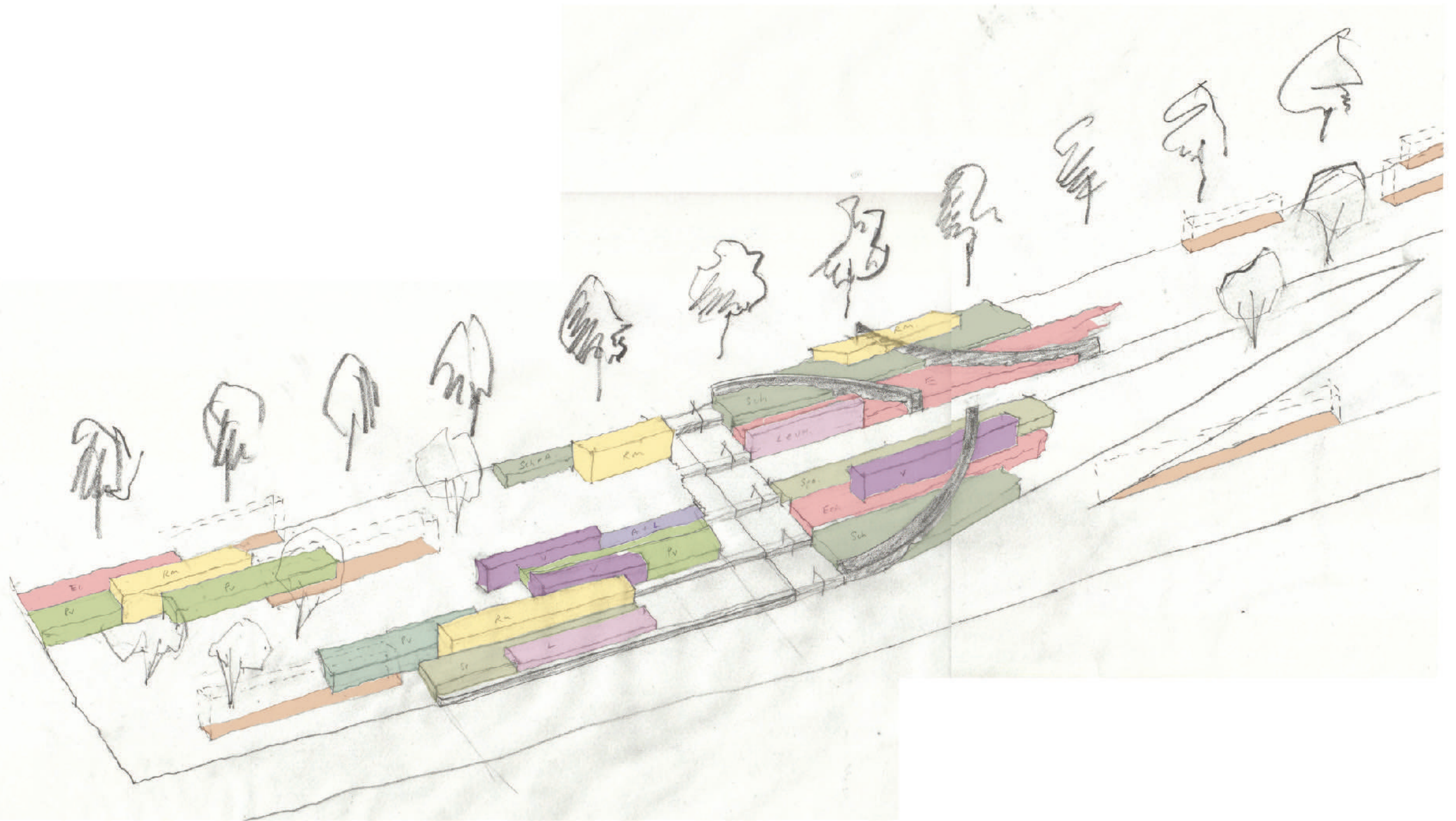

North Americas

Low Foliage Layer (<300mm tall)			
Coreopsis verticillata 'Zagreb'	0.5	350	50
Echinacea paradoxa	0.5	1200	50
Echinacea purpurea 'Kims Knee High'	0.5	600	50
Geum triflorum	0.5	300	50
Liatris aspera	1	750	100
Oenothera missouriensis incana	2	300	200
Penstemon cobaea var. purpureus	0.5	600	50
Ruellia humilis	1	300	100
Sporobolus heterolepis	1	750	100
Yucca flaccida/filamentosa	0.075	1500	7.5000
	7.575		
Medium Foliage Layer (300-600mm tall)			
Asclepias tuberosa	0.5	500	50
Aster azureus	0.25	750	25
Aster oblongifolius	0.25	600	25
Callirhoe bushii	0.25	750	25
Echinacea pallida	0.25	1200	25
Parthenium integrifolium	0.1	750	10
Schizachyrium scoparium	0.25	750	25
Solidago speciosa	0.25	750	25
	2.1		
Tall Foliage Layer (>600mm tall)			
Andropogon gerardii	0.1	1200	10
Silphium laciniatum	0.1	2000	10
Silphium terebinthinaceum	0.1	3000	10
	0.3		
Total plants / m2	<u>9.975</u>		

Shaded areas: Low Foliage Layer (>300mm tall)			
Aster divaricartus	1	450	100
Heuchera villosa	2	300	200
Phlox divaricarta	2	300	200
Polemonium reptans	2	300	200
	7		
Shaded areas: Medium Foliage Layer (300-600mm tall)			
Aster macrophyllus 'Twilight'	0.5	1000	50
Gillenia trifoliata	0.5	800	50
Rudbeckia fulgida deamii	1	600	100
Solidago caesia	0.5	700	50
	2.5		
Total plants / m2	<u>9.5</u>		











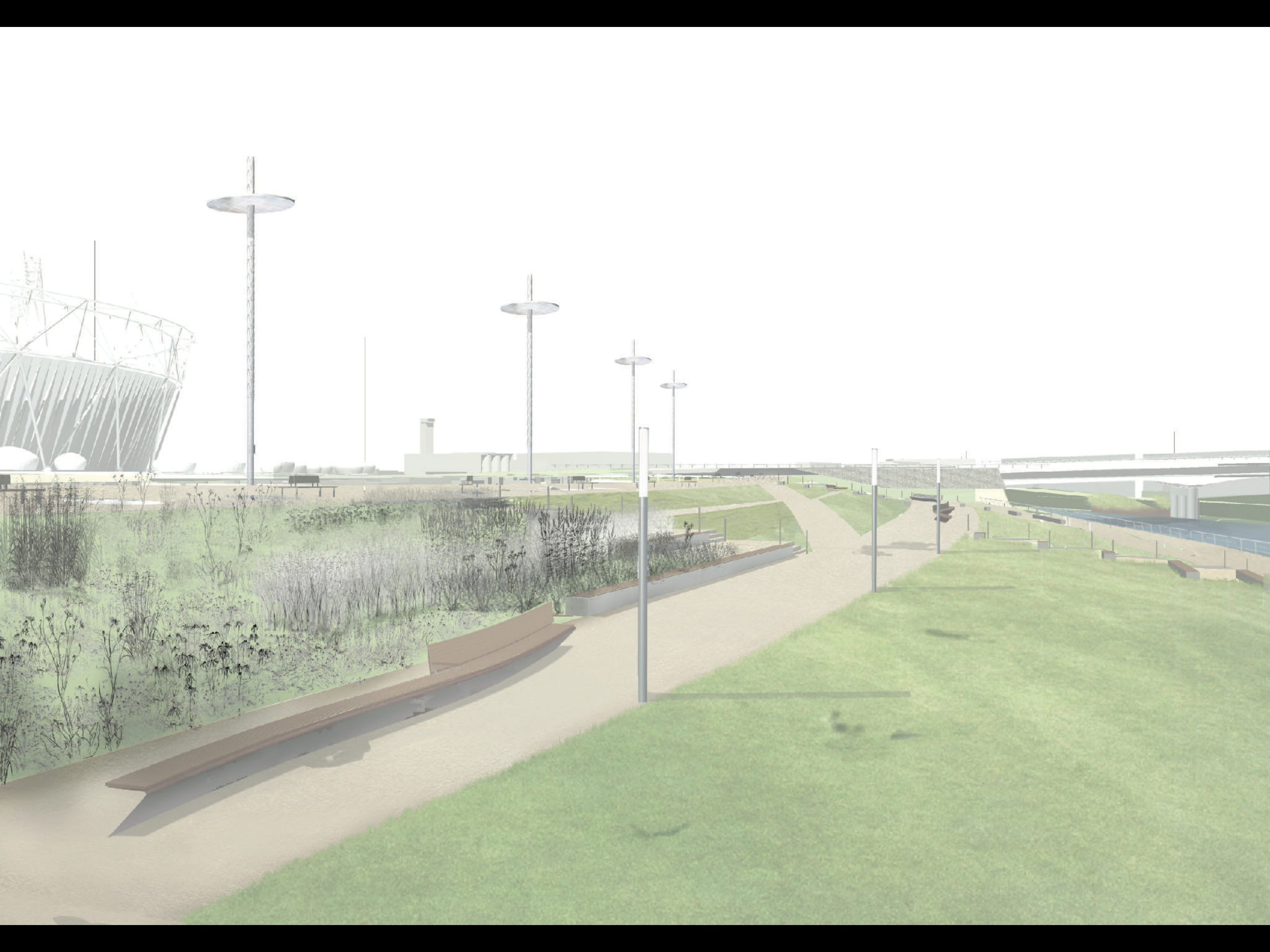

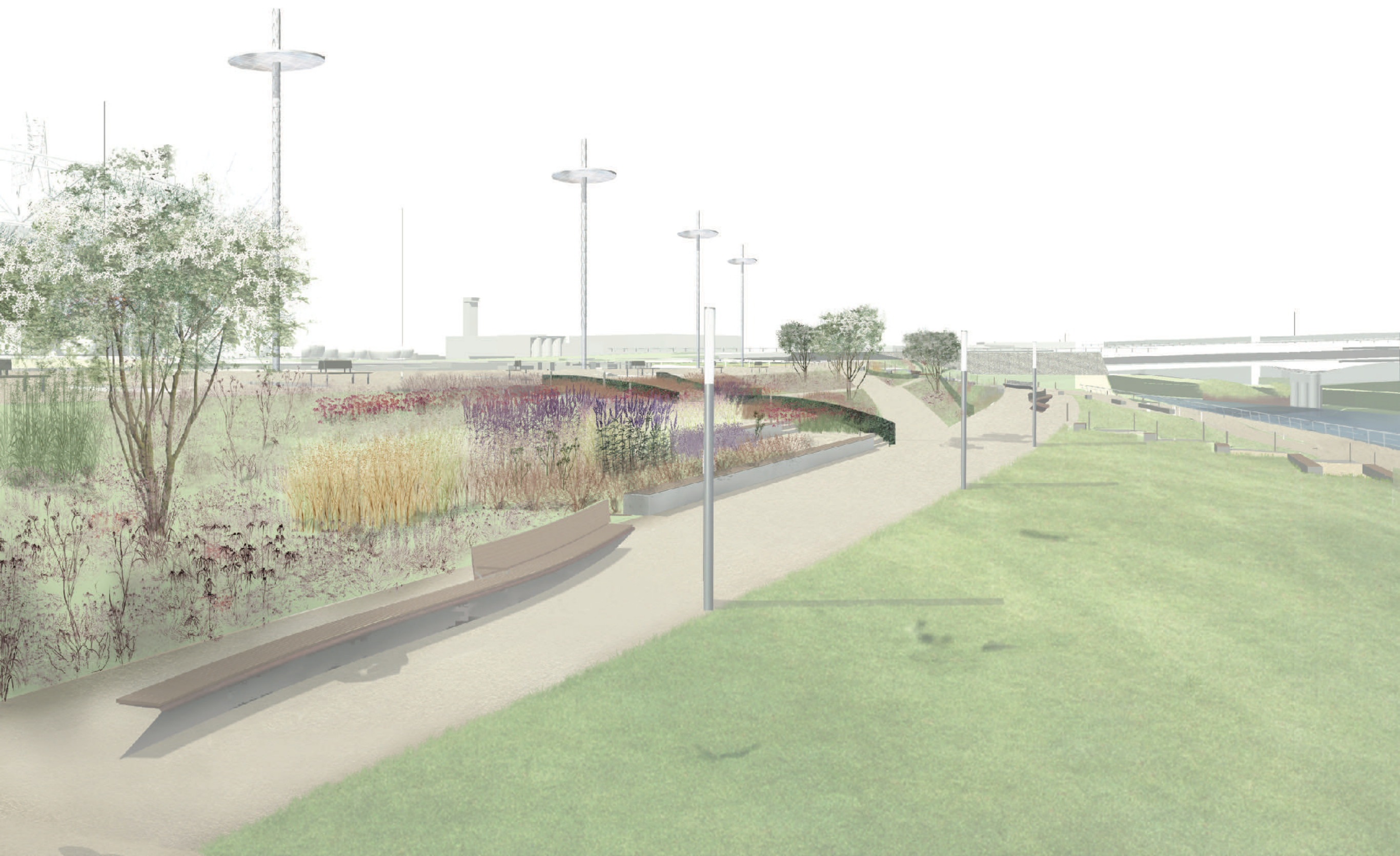

ZONE 1

Do not scale this drawing.
Notes:

-
- A diagram of a circular pond. A north arrow points upwards from the center of the pond. A scale bar is located to the right of the pond, with markings at 0, 2, 4, and 8.

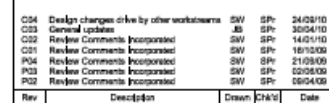

Construction	C1. Underground services (refer to Note 4); C2. Contaminated land (refer to Note 5); C3. Stability of existing river wall (refer to Note 6);
Access	C4

Creator	Prepared by

Drawing Time

Project Title	
---------------	--

SW	SP _T	NM
Date	Scale	Size

Drawing No.	Sheet.	Rev.
7180-LPR-LSF-L-DGA-2207		C04

ZONE 2

North America







Please refrain from sitting
on seat/step units or using
them as work benches.
These are finished
items of works.