

Welcome

Adam White FLI PLI

President of the Landscape Institute

Director at Davies White Ltd - @davies_white

**Landscape
Institute**
Inspiring great places

Agenda

- 1. Welcoming address from Adam White, President of the Landscape Institute**
- 2. To approve the minutes of the Annual General Meeting held on 02 November 2017**
- 3. President's Report**
- 4. Report from Dan Cook, CEO**
- 5. Presentation from Carolin Göhler, Honorary Treasurer**
- 6. To receive and approve the Trustees' Report and Annual Accounts of the Institute for the financial year ended 31 March 2018**
- 7. To approve the re-appointment of Sayer Vincent as the Institute's auditors**
- 8. Formal business: AOB**
- 9. Adam White – the year in view: 2019**

2. To approve the minutes of the AGM held on 02 November 2017

3. President's Report

Adam White FLI PLI

President of the Landscape Institute

Director at Davies White Ltd - @davies_white

Presidents' Reception 2018

Headline
sponsor



Landscape
Institute
Inspiring great places





IFLA Congress 2018, Singapore

International Federation of Landscape Architects



18 – 21 JULY 2018

BIOPHILIC CITY | SMART NATION | FUTURE RESILIENCE
Held in conjunction with Singapore Garden Festival

**Landscape
Institute**
Inspiring great places





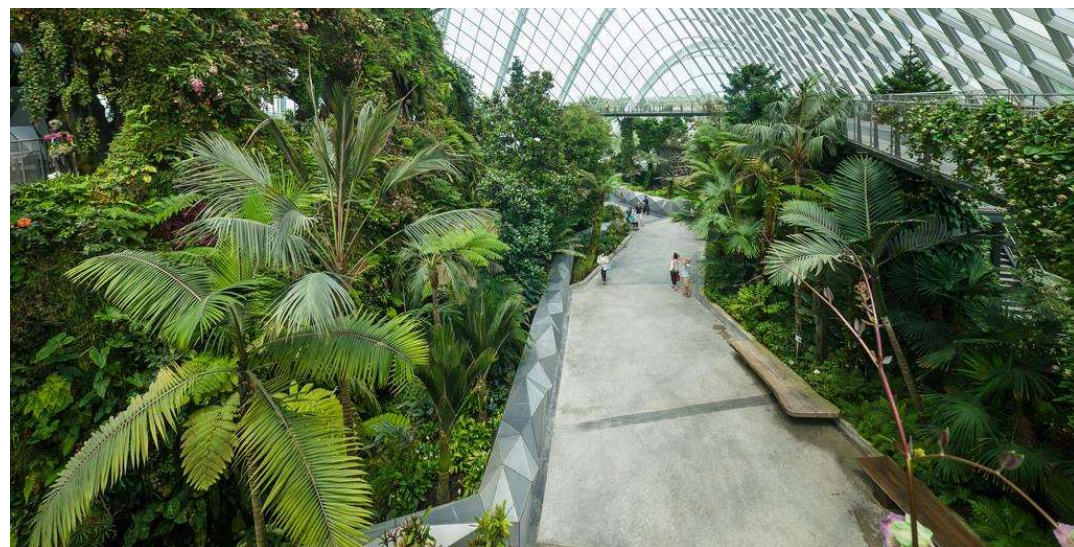



Engaging with partners #LandscapeUnited



Conference 2018: Valuing Landscape

- **Climate Change Adaptation & Mitigation**
- **Water Management & Flood Alleviation**
- **Place & Communities**
- **Health & Well-being**
- **Land & Property Values**
- **Investment**
- **Labour Productivity**
- **Tourism**
- **Recreation & Leisure**
- **Biodiversity**
- **Land Management**



Source: Green Infrastructure NW – Valuation Toolkit

**Landscape
Institute**
Inspiring great places

GOLD SPONSORS



SILVER SPONSOR



BRONZE SPONSORS



IFLA EUROPE
INTERNATIONAL FEDERATION
OF LANDSCAPE ARCHITECTS

Landscape
Institute
Inspiring great places



UNIVERSITY
of
GREENWICH

SUPPORTERS



STRATEGIC PARTNERS



Landscapes
for life
.org.uk

















COMMON GROUND

IFLA WORLD CONGRESS 2019
Oslo, Norway 18–20 September



Norwegian Association
of Landscape Architects
www.landskapsarkitektur.no



International Federation of
Landscape Architects
www.iflaonline.org

Technical organiser
Gyro Conference AS
IFLA2019@gyro.no



EBBSFLEET GARDEN CITY

An international competition launched by Landscape Institute in collaboration with Ebbsfleet Development Corporation and NHS England to find the best creative and inspiring ideas to help shape the landscape of what will be the first new Garden City of the 21st Century.



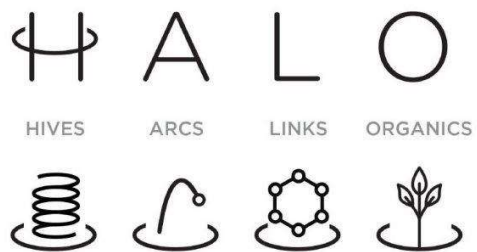

.... a model for growing a healthy infrastructure

Streamed CPD and training



Back Soon....

- 10:00 - 10:30** Social Media Marketing – Making it deliver
Fern Eyre Morgan, FEYM Digital
- 10:35-11:05** Using 3D Technology in the AEC Sector
Kadline James / Ewen Morrison, Hobs Studios
- 11:35-12:05** Animated Landscape
Matthew Parker, Room60
- 12:10-12:40** Digitisation, Construction and BIM Level 3
Mike Shilton, Keysoft Solutions
- 13:40-14:10** The future of design will be Immersive
Johan Hanegraaf, Peiter Hoen, Mecanoo
- 14:15-14:45** Smart Design for a smart future
Michael Cowdy, McGregor Coxall
- 15:15-15:45** The digital future of the professions
Paul Wilkinson, pwcom
- 15:50-16:20** Key to the City: Using Augmented Reality in the Public Realm
Neil Manthorpe, Atkins

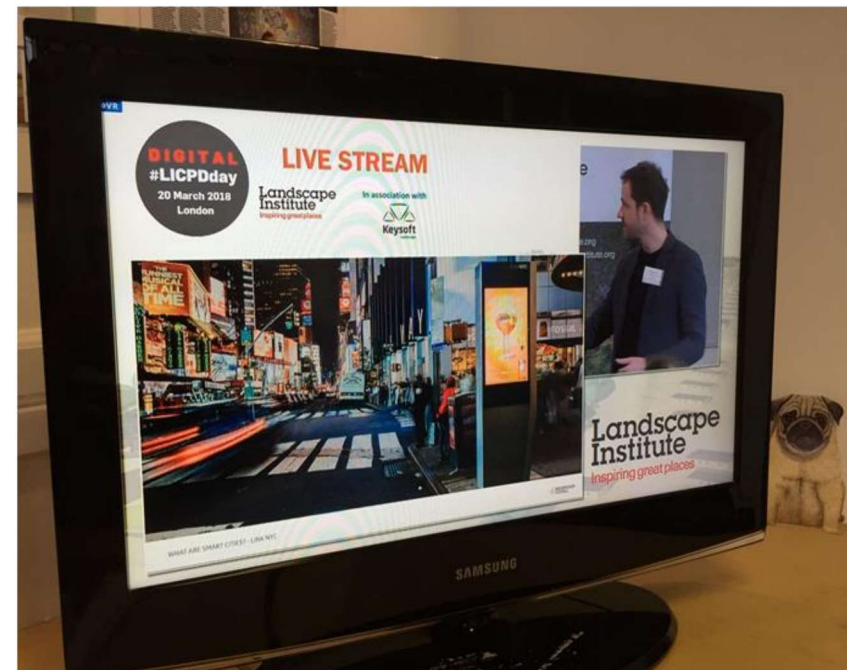

Entry standards workshop

Manchester – led by Dan & Poppy



Green Learning Environments

Conference, Liverpool



Bluebell Park School



All-Party Parliamentary Gardening and Horticulture Group

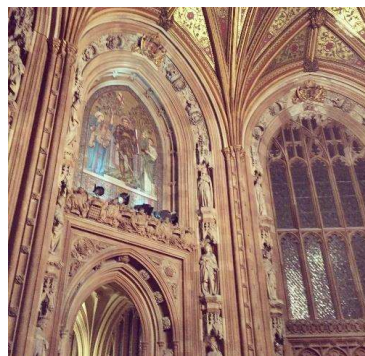
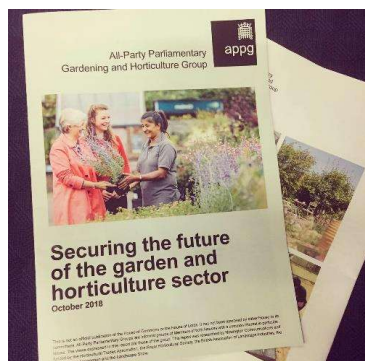

Central Scotland Green Network Year of Young People 2018



The Landscape Show

The Future State of Landscape

Landscape

THE INDUSTRY TRADE SHOW

Tuesday 18 & Wednesday 19 September 2018 Battersea Park, London



The Landscape Show

Landscape Institute Pecha Kucha
“Things that makes me go WOW!”

Landscape

THE INDUSTRY TRADE SHOW

Tuesday 18 & Wednesday 19 September 2018 Battersea Park, London



LI College of Fellows

Royal Botanical Gardens Edinburgh

**Landscape
Institute**
Inspiring great places



Jellicoe Lecture 2018

Royal Botanical Gardens Edinburgh



LI Advisory Council Meeting **Edinburgh, Scotland**

**Landscape
Institute**
Inspiring great places



Futurescape Conference

Sandown Race Course

(20th November 2018)



An evening with the PLI

Engaging young people in landscape design

Edinburgh College of Art – University of Edinburgh

Landscape
Institute
Scotland



THE UNIVERSITY OF EDINBURGH
Edinburgh College of Art



Digital Skills CPD Day

Manchester #LICPD Day

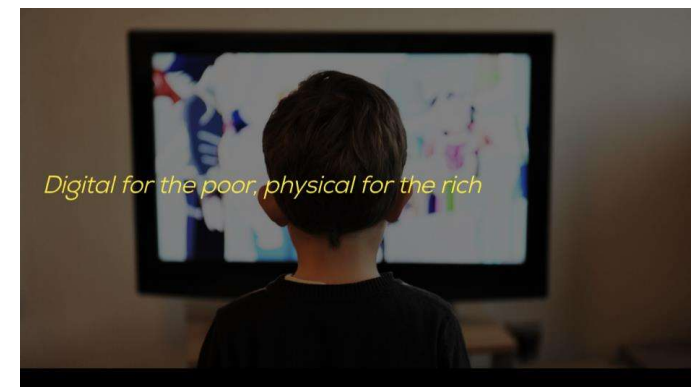
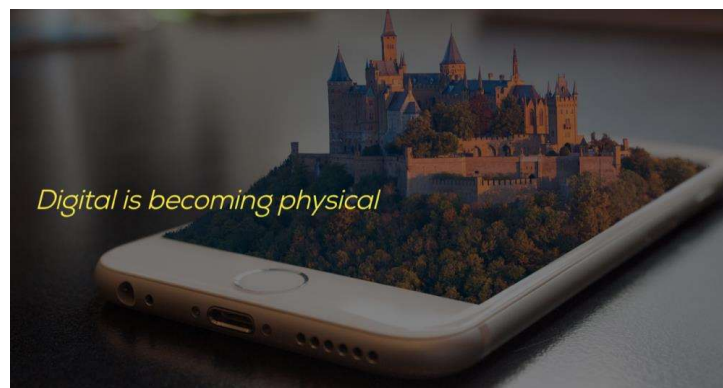
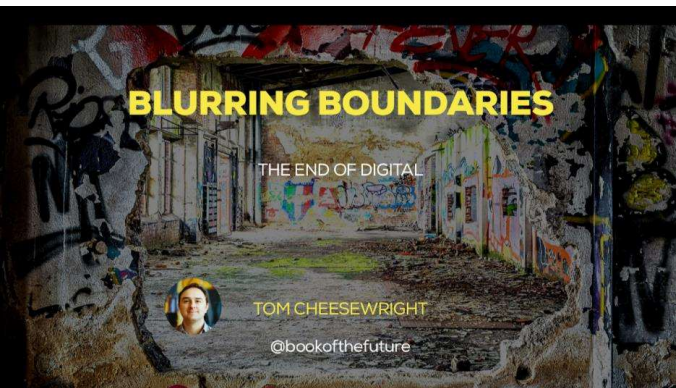

TAKEAWAYS

- Physical and digital are merging
- This creates huge opportunities but also risks
- Digital isolation may be a wealth issue
- Protect the physical design of the public realm

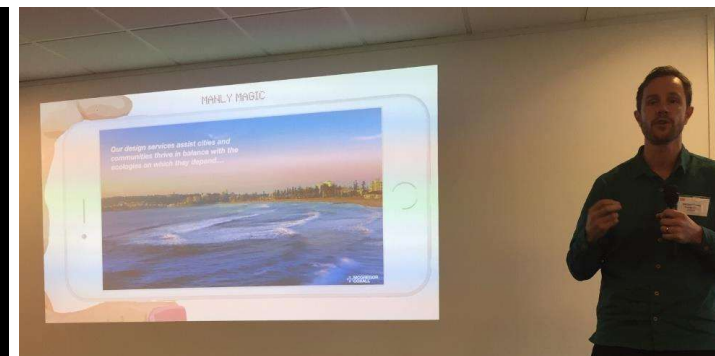



Landscape
Institute
Awards
2018

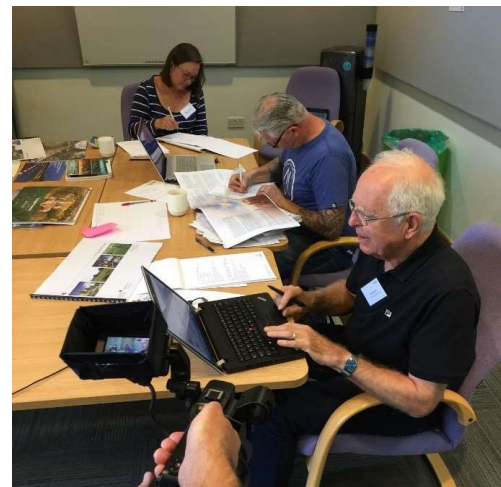

Landscape Institute Awards



Your Brain on Nature: Why Nature Makes us Happier, Healthier and More Creative

Florence Williams

Author, *The Nature Fix*

@flowill



Adding Value Through Landscape - WINNER

Maritime Streets, Barrow-in-Furness



Landscape Architect: FHA
Client: Barrow Borough Council
Engagement: FHA & Growing Well
Engineering: Price & Myers
CDM: Baker Mallet
Contractor: Gavin Jones Ltd
Plant Supplier: W Crowder Sons Limited

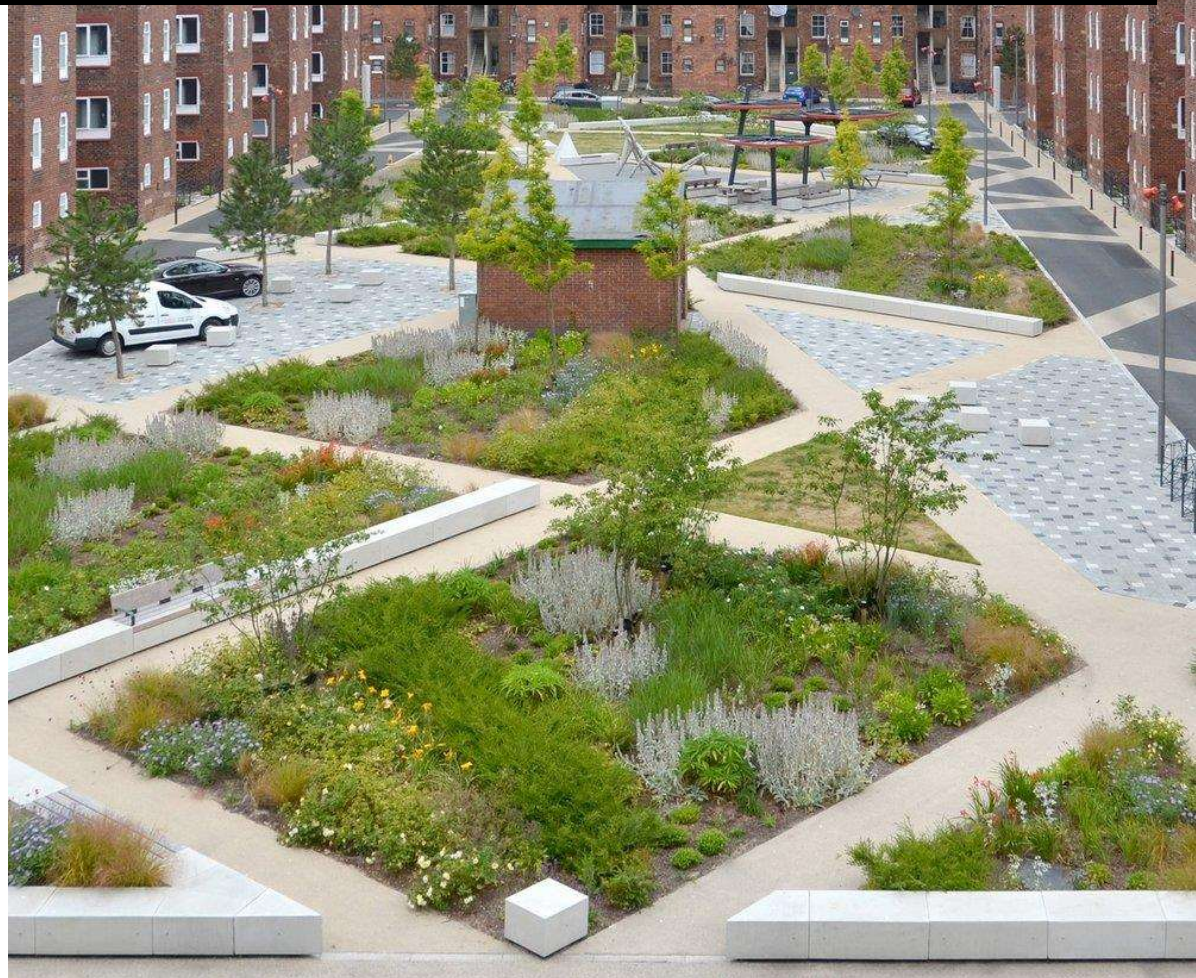

Design for Large Scale Development - WINNER

Learning Forest, Singapore Botanic Garden



Landscape Architect: **Stephen Caffyn**
Client: **National Parks Board**
Engineering: **ARUP**
QS: **Turner & Townsend**
Contractor: **Princes Construction**





Design for Temporary Landscape - WINNER

Forest of Imagination, Bath



Landscape Architect: **Grant Associates**

Client: **Forest of Imagination**

Collaborators:

5x5=creativity, Herman Miller, Bath Spa University, Feilden Clegg, Bradley Studios, Imaginnovation, Carpenter Oka and Woodland, The House of Fairy Tales, Illustrious, Aerocene Plant Supplier: Wyevale Nurseries



Science, Management and Stewardship - WINNER

Thamesmead



Landscape Architect: **Land Management Services Ltd**
Client: Peabody Trust
Ecology: **Gary Grant**



Dame Sylvia Crow Award - WINNER

Quarry Garden, Shanghai Chenshan Botanical Garden



Landscape Architect: Yufan Zhu
Client: Shanghai Chenshan Botanical Garden
Engineers: Zhongyuan Design Consultants



Planting Design, Horticulture & Ecology - WINNER

Beech Gardens and The High Walk, Barbican Estate



Landscape Architect: **Nigel Dunnett & The Landscape Agency**
Client: **City of London**
Plant supplier: **Palmstead Nurseries**
Green Roof materials: **ZinCo**



AND The College of Fellows Award - WINNER

Beech Gardens and The High Walk, Barbican Estate



Landscape Architect: **Nigel Dunnett & The Landscape Agency**
Client: **City of London**
Plant supplier: **Palmstead Nurseries**
Green Roof materials: **ZinCo**



AND The College of Fellows Award - WINNER

Beech Gardens and The High Walk, Barbican Estate



Landscape Architect: Nigel Dunnett &
The Landscape Agency
Client: City of London
Plant supplier: Palmstead Nurseries
Green Roof materials: ZinCo



Design for Small Scale Development - WINNER

South Gardens, Elephant Park, South London



Landscape Architect: Churchman Landscape Architects
Client: Lendlease
Architect: Maccleanor Lavington
Engineers: Robert Bird Group
Arboriculture: Treeworks Environmental Practice
Public Realm Landscape Architects:
Ecologist: Gary Grant
Contractor: Lendlease
Landscape Contractor: Gavin Jones
Plant supplier:

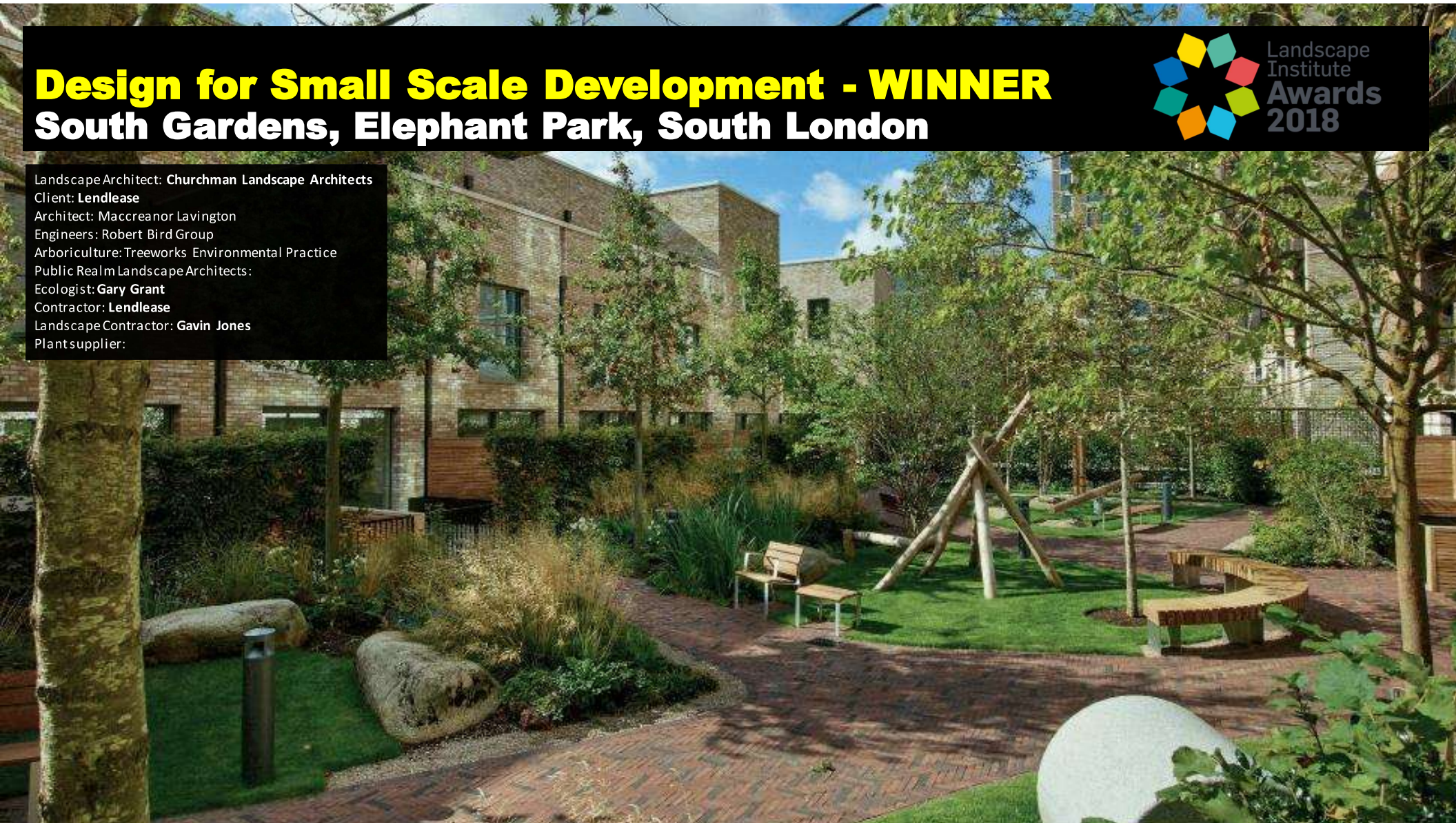

Design for Small Scale Development - WINNER

South Gardens, Elephant Park, South London



Landscape Architect: Churchman Landscape Architects
Client: Lendlease
Architect: Maccreehan Lavington
Engineers: Robert Bird Group
Arboriculture: Treeworks Environmental Practice
Public Realm Landscape Architects:
Ecologist: Gary Grant
Contractor: Lendlease
Landscape Contractor: Gavin Jones
Plant supplier:



The Presidents Award - WINNER

South Gardens, Elephant Park, South London



Landscape Architect: **Churchman Landscape Architects**
Client: **Lendlease**
Architect: **Maccleanor Lavington**
Engineers: **Robert Bird Group**
Arboriculture: **Treeworks Environmental Practice**
Public Realm Landscape Architects:
Ecologist: **Gary Grant**
Contractor: **Lendlease**
Landscape Contractor: **Gavin Jones**
Plant supplier:

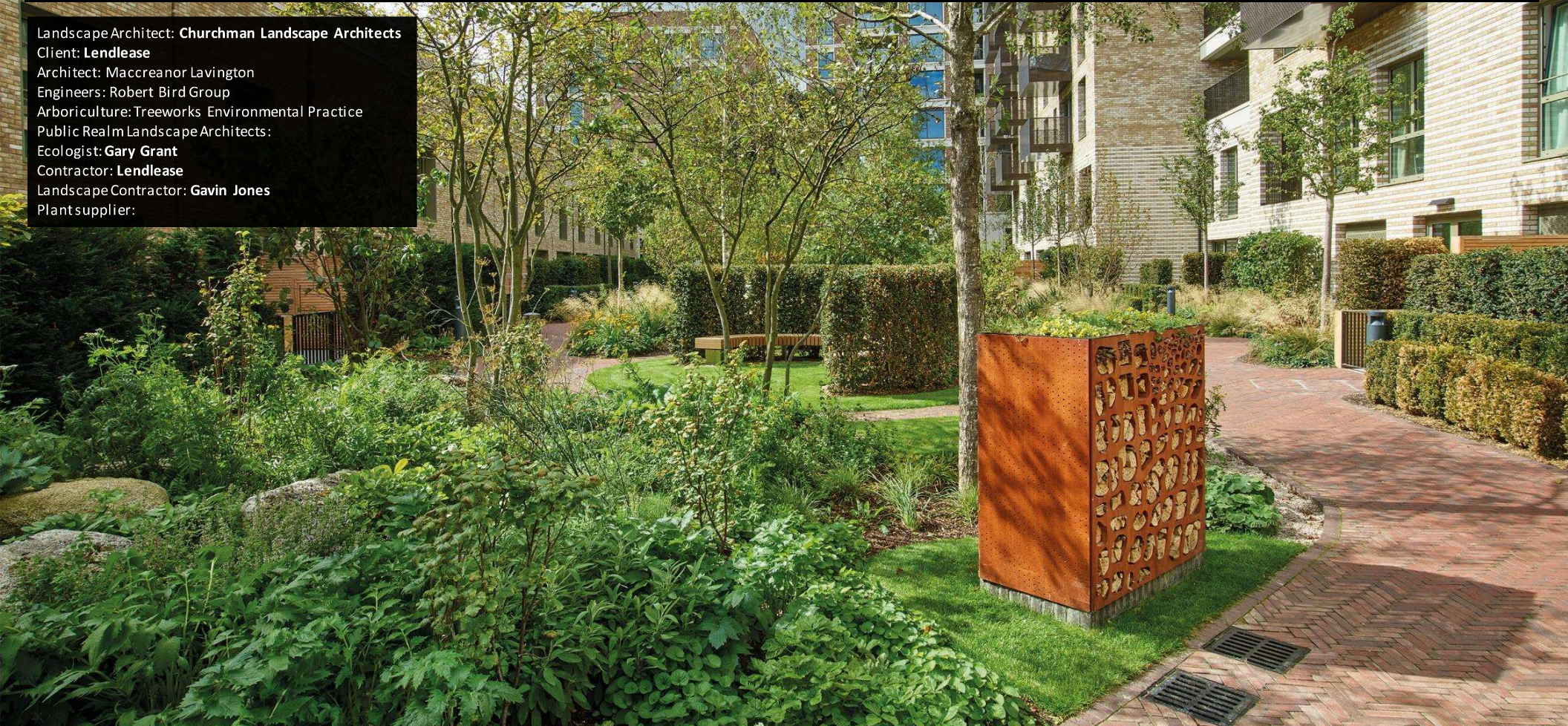



BALI Awards 2018



National
Landscape
Awards
2018

**BALI Design Excellence
Award Category 2018
Sponsored by**

**Landscape
Institute**
Inspiring great places



BALI Awards 2018



National
Landscape
Awards
2018

**BALI Design Excellence
Award Category 2018
Sponsored by**

**Landscape
Institute**
Inspiring great places



The RHS Green Plan IT Challenge

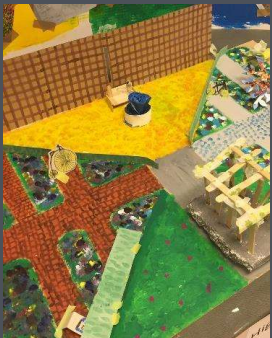

The RHS Green Plan IT Challenge

GREEN PLAN IT ADAM WHITE



INFORM

This month landscape architect **Adam White** provides an insight into the RHS Green Plan IT Challenge which reconnects children with nature, whilst raising awareness of the various career opportunities within the landscape profession

As a child I was inspired by nature and plants. Today, I still hold the same fascination with seeing a seed germinate and grow. Nothing beats growing your own veges, and as my Uncle Syd says: "It's cheaper than therapy and you get tomatoes."

At 13 years old I established a 'friends of' group in our village to help restore and regenerate the local pond which was overgrown and uncared for. 'Project Lily Pit' involved surveying, analysing and then designing a scheme (including making a scale model) to make the pond more accessible and valuable to the local wildlife and community. I managed to secure £2,000 from the council and then with

"THIRTY YEARS ON AND I AM STILL ON A MISSION TO RECONNECT FAMILIES WITH NATURE"

the help of volunteers we transformed the pond and surrounding landscape into a local beauty spot. Little did I know at the time this was my first step to becoming a landscape architect.

Thirty years on and I am still on a mission to



reconnect families with nature and in 2012 I was made Fellow of the Landscape Institute for my efforts. With an ever-growing skills gap in our industry, it is now more important than ever that we inspire and encourage more young people to choose a career in landscape by working



together across this exciting profession. As President of the Landscape Institute I was therefore delighted to hear about the RHS schools campaign, The Green Plan IT Challenge, inspiring young people to choose landscape as future career is right at its core.

The Green Plan IT Challenge teaches students about nature and plants and builds their skills and confidence. Over the course of 10 weeks in the Autumn term, students across the UK are tasked with researching, planning and building a model showing their ideas of what would make an innovative or exciting new garden, park or public space for their school or local community.

In 2018 I was lucky enough to be invited to be a speaker and join a panel of assessors at two of the celebration days. I was very impressed with the quality of the designs and the amount of research that went into making sure they stood up to vigorous assessment from a panel of industry experts. Teams are matched with mentors from the horticulture, garden design and landscape industry. They then guide them through the project, offering

knowledge about landscape design, science, planning and management.

Green Plan IT is designed to be student led and allows them to explore community needs and environmental issues, as well as grow their understanding of how plants and nature play such a valuable role in our lives. Many of the students are surprised to hear how similar the process is to that of a chartered landscape architect and even more surprised to discover

"IT IS NOW MORE IMPORTANT THAN EVER THAT WE INSPIRE AND ENCOURAGE MORE YOUNG PEOPLE TO CHOOSE A CAREER IN LANDSCAPE"

they could be paid to do it in the future!

The great thing about this initiative is how relevant it is to a number of curriculum subjects including Science, D&T, Geography and Art, as well as Personal Social and Health Education (PSHE) and Citizenship. During my involvement I saw children develop skills in leadership, teamwork, presentation skills, creative thinking and self-confidence.

In the spring the RHS will no doubt again be on the lookout for volunteer mentors, assessors and most importantly teams of year 8-9/S2-3 students to take part in this year's RHS Green Plan IT Challenge. If you think this is something you could help with do get in touch with the RHS Green Plan IT team at greenplan@rhs.org.uk.

ABOUT ADAM WHITE FLI

Adam White FLI is a director at Davies White Ltd, a double RHS Gold Medal, double BBC Topical's Choice and RHS Best in Show award-winning Chartered Landscape Architects practice. He is the President and a Fellow of the Landscape Institute. Social media: [@davieswhite](https://twitter.com/davieswhite) www.davieswhite.co.uk



GARDEN DESIGN JOURNAL

JANUARY 2019 / ISSUE 190 / £8

THE JOURNAL OF THE SOCIETY OF GARDEN DESIGNERS

SGD

WILD COUNTRY
A ranch turned garden retreat in Texas

TOP OF THE CLASS

THE FINALISTS IN THE SGD STUDENT DESIGN AWARDS 2019

Top tips on adjudication
The hot new trade nursery for designers
PLUS outdoor kitchens & mentoring advice

WORKING TOGETHER

SGD Chair Sarah Morgan and LI President Adam White describe areas where the organisations can collaborate to further promote the landscape industry

TALKING POINT

WHAT DO YOU THINK?
email us at
gdj@jamespembroke
media.co.uk



Sarah Morgan
Chair of the SGD Sarah Morgan worked in a commercial nursery as a teenager, before taking a degree in horticulture. She managed planting schemes with a local authority and then established her own garden design practice. She is also an educator and lecturer.



Adam White
President of the LI Adam White is a Chartered Landscape Architect. He attended Russett Horticultural College and Manchester Metropolitan University. Having worked for the environmental charity Groundwork, he established Davies White with Andrius Davies in 2008.

HAVING MET AT a number of industry events and awards over the past year, we have discussed our similar values when it comes to garden and landscape design as a profession. As representatives of the SGD and LI, we have also met with BALI and APFLD to look at ways all of us can pull together to improve professional standards in landscape design.

In law, a garden designer has exactly the same responsibilities for health and safety as a landscape architect, and they have the same requirement under their respective code of conduct for correct professional appointment. The skills one needs for garden design are transferable, and overlap with the skills required to be a landscape architect. Professional garden designers and landscape architects, therefore, often find that their field of work overlaps, and whether you come from a garden design or landscape architecture background, choosing a career in the profession poses similar challenges and opportunities. It makes sense that both organisations share best practice and promote

each other's work to a much wider audience.

Witnessing the many changes and developments in the wider industry, we must acknowledge that we cannot stand still, sticking with the same skills as before – constant learning and up-skilling propels us forward and keeps our work fresh. It is important to be challenged and prodded to stretch into new fields of knowledge, and to admit when we could do better by adopting new methods or processes. Attending industry events, such as the SGD and LI

conferences, as well as seminars and courses, trade shows and CPD days, is the best way to stay up to date and continue to grow. That is why both organisations have a CPD requirement to be a Member.

Sustainable steps

We are all working within a changing environment. All landscapes, large and small, are important to sustain us physically and emotionally. Whatever we do in our work, we will have some impact, good or bad, on the environment, now and in the future. Being mindful that during our short careers we have the opportunity to carefully select materials, plants and practices that work in harmony with nature and her inhabitants is a responsibility worth embracing.

Relaxation of planning laws and building regulations should be challenged by all of us who care about landscape, and we need to insist that best practice in sustainable building and landscape design go hand in hand. We can achieve this by adopting consistent good practice right through the industry, through universal specifications and contracts, good communication with contractors and realistic budgets.

Linking gardens and wider landscapes for a common environmental purpose involves close collaboration across the industry. Finding flexible solutions to the changing climate and biological systems will challenge us all to dig deep to research and adopt best construction and management techniques. Each of us in the industry can decide which problem we are going to tackle, and it is together that we will find a solution.

This all feeds into a big challenge for both our organisations: changing the way people interact with outdoor space. The majority of the UK population lives in an urban environment and people are getting more and more detached from nature. Author Richard Louv defines 'nature deficit disorder' as "what happens when people, particularly children, spend little or no time outside in natural environments, resulting in physical

and mental problems, including anxiety and distraction".

Time in nature is not a luxury – it is essential to a healthy society. We need to promote what poets and philosophers have known for decades – place matters. We must continue to uncover and celebrate the science behind nature's positive effects on the brain. Public spaces and private gardens should be seen as essential requirements in any strategic development plan.

Looking ahead

One of the most important issues we both wish to address is educating the young about and encouraging careers in the industry. It is vital that we tackle the growing skills gap and inspire and encourage more young people to choose a career in landscape.

The LI's new campaign, Choose Landscape, is a step in the right direction. The campaign makes clear the range of opportunities in landscape for all kinds of people – from someone who loves creative design to a science enthusiast, from those who are passionate about tackling climate change, to those who just love using the latest digital technology. All of these passions and skills are needed in the industry.

The SGD is working closer with FE colleges, attending career events, and meeting with the RHS to discuss a smoother transition from horticulture and design courses to the many excellent garden design courses in higher education. Working with schools to sow the seeds of opportunity in landscape design, so that students can make the right choice first time round, is an area that both organisations feel passionately about, and presents a challenge worth tackling together.

Whether you are a garden designer or landscape architect, a horticulturist or contractor, we all need to work together and collaborate. We have far more in common than not, and can do so much more together than apart. Gardens may have boundaries, but that doesn't mean our related professions should. ☐

Presidents Diary 2018/19/20

2018		
29 th October	House of Commons, APPGHG	London
1 st & 2 nd November	Jellicoe Lecture/ LI AGM	Edinburgh
15 th November	2 nd BALI, SGD & SGD Joint Webinar	Global
20 th November	Futurescape – Speaker, Digital Skills	Surrey
21 st November	Play Symposium, Welsh Parliament	Cardiff
22 nd November	LI Awards	London
28 th November	Garden Media Guild Awards - Judge	London
29 th November	Health, wellbeing & place CPD Day	Cardiff
5 th December	RHS Green Plan Judging	Wisley
5 th December	LI London	London
7 th December	BALI Awards	London
11 th December	LI Board	London
12 th December	RHS Green Plan Judging	Chelmsford
2019		
23 rd January	Palmstead Conference - Speaker	Kent
24 th January	Landscape Institute AGM - Chair	London
1 st February	SGD Awards	London
11 th February	RHS Chelsea Press Conference	London
8 th February	Prolandscaper Business Awards	London
5 th March	FutureBuild (formally Ecobuild) - Seminar Chair	London
12 th March	Futurescape Spring	Surrey
15 th March	APL Awards - Speaker	London
16 th March	FOLAR Play Symposium - Chair	Reading
21 st March	CMLI Graduation Evening - Host	London
May	RHS Chelsea - RHS Back to Nature	London
June	Landscape Institute 90th Birthday	UK Wide
June	Gardeners World Live - Speaker	Birmingham
July	RHS Hampton - RHS Garden	Surrey
Sept 18 -20	IFLA World Congress - Speaker	Oslo, Norway
September	The Landscape Show	London
19 th November	Futurescape	Surrey
November	IFLA Europe General Assembly	Ankara
2020		
June	LI Conference “At scale”	Birmingham
Aug 13-15	IFLA World Congress “Future Tense”	Malaysia



RHS CHELSEA - MAY 1929



3rd April 1924

3, LITTLE CLOISTERS,
WESTMINSTER ABBEY.

Dear Sir,

I have seen your name in the "Gardeners Chronicle" in connection with a proposed Society of Garden Architects. I was not able to attend a meeting which took place on February 20th but I should be very grateful to receive any information re this proposed society.

I have worked in connection with garden design for some years. I find it very difficult or almost impossible to meet other people doing the same type of work and think that the kind of society proposed might be very interesting.

I enclose stamped addressed envelope.

Yours Truly
Aldyth Donaldson
(Mrs)

Landscape Architecture.

A Diploma Course Established at Reading University.

WHEN the Royal Horticultural Society so generously and successfully organised the International Conference on Garden Planning and filled its two halls with a comprehensive exhibition in October, 1928, it appeared inevitable that the results would be far-reaching.

Anticipation in this direction has already been turned to realisation and in such a way that the effect will almost certainly exercise a potent influence on the progress and practice of garden design far beyond the present day. It is, indeed, not too much to hope that generations yet unborn will look back to that exhibition as the crystallisation of what had hitherto been incoherent and desultory effort into organised endeavour to improve the condition of the profession and place it on an equal footing with its kindred. For too long in Britain it was not realised that garden design, whilst demanding training and capability akin to both architecture and horticulture, was a pursuit that came midway between the two. Those practising the profession were well aware of the difficulties of obtaining just that training in essentials that is so necessary in any calling involving a general knowledge of design, construction and horticulture and a special and detailed knowledge of certain phases of the work that come under their control.

The first direct result of the conference and exhibition was the formation of the Institute of Landscape Architects, the organisation of which is now as complete as constant and arduous work during the period of its existence can make it.

But the members of the institute recognised from the first that this was only a means unto an end

and that their efforts should be turned to an endeavour to place within the range of future practitioners advantages and opportunities they themselves had never possessed. The organisation of the members of the profession into an association for mutual aid was highly commendable, but this alone was obviously insufficient to justify existence. The first serious effort of the institute was therefore devoted to evolving a scheme of education of young people desirous of entering the profession seriously. Each individual looked at it from the point of view of some particular phase of education, the opportunity of which they had lacked or found difficult to obtain and in frequent discussions it was rendered easy to arrive at a fairly definite conclusion of what the training should consist. A general syllabus was prepared, based partly on what has been done in other countries, but modified to suit national conditions.

The Senate of the University of Reading have decided to establish a Diploma Course of Landscape Architecture. It is specially designed for those who intend to take up this subject as a career. The duration of the course is to be three years. In the first year it extends for 30 weeks and the second and third years 35 and 33 weeks respectively. It is proposed to cover as far as practicable every necessary phase of the subject: art, botany, book-keeping, physics, chemistry, surveying and levelling, horticulture, building construction, wherever these subjects can be reasonably expected to prove beneficial to the student. The work will not be restricted to mere lecture-hall treatment, but the application of the various subjects will be demonstrated practically at the Horticultural Station, Shinfield. Special arrangements have been made whereby students can be excused attendance at such portions of the course as may be deemed proper and every effort has been made to render the training as complete as is practicable within the period.

The session begins on October 10th and a copy of the prospectus and all particulars can be obtained on application to the Registrar, University of Reading.

A course of instruction is therefore now available that has hitherto been non-existent in Britain and it is anticipated that other educational centres will shortly adopt a similar course.

It must not be assumed that anyone expects students taking the course and gaining the diploma will be turned out fully fledged and competent landscape architects. Nothing but the pursuit of practical experience can achieve this. It is claimed that students having acquired a thorough foundation of essential instruction will be able to build on that foundation a sound, practical knowledge gained by subsequent experience and to apply that experience in a technical and logical way.—Communicated.

WINDOLITE

(Patent. Reg. Trade Mark)

SUPERSEDES GLASS IN THE GARDEN

Windolite, the only practical substitute for glass, admits all the light but keeps out cold and wet.

It is the perfect material for frames and handlights of any size or shape.

Light—Flexible—Unbreakable.
Easy to cut and fix.

Windolite gives a new lease of life to old glasshouses.

Use it yourself and stock it for resale!

In rolls 2 ft. wide at 6/- per yard (6d. postage under £1). Full Trade Discounts.

WINDOLITE LTD., (Dept. O), HARLOW, ESSEX.

AN ADVERTISEMENT IN "THE N. & S." IS SEEN BY BUYERS ALL OVER THE WORLD.

Forty Years A-Growing

This year the I.L.A. is forty years old. To celebrate the occasion we have asked L. J. Fricker, who is studying the history of the Institute, to give a brief survey. The illustrations in figures 3-10 represent landmarks in the development of ideas or new departures in the range and scale of the work carried out by members of the Institute.

by L. J. Fricker, DipLA (Reading)
Research Fellow, School of Architecture, Portsmouth College of Technology

Chronology

October 1922

International Exhibition of Garden Design.
Stanley V. Hart distinguished by lack of any or British Section ages necessity of forming an association of garden architects.

20 February 1925

Proposed by Stanley V. Hart to the British Association of Garden Architects.

21 May

Stanley V. Hart distinguished by lack of any or British Section ages necessity of forming an association of garden architects.

12 June

Proposed by Stanley V. Hart to the British Association of Garden Architects.

20 June

Proposed by Stanley V. Hart to the British Association of Garden Architects.

9 July

Proposed by Stanley V. Hart to the British Association of Garden Architects.

11 December

Proposed by Stanley V. Hart to the British Association of Garden Architects.

22 October

Proposed by Stanley V. Hart to the British Association of Garden Architects.

28 January 1929

Proposed by Stanley V. Hart to the British Association of Garden Architects.

11 February

Proposed by Stanley V. Hart to the British Association of Garden Architects.

10 December

Proposed by Stanley V. Hart to the British Association of Garden Architects.

Phase I 1929-1939

Although we need a definitive study of the Institute's development, this is no more than a sketch, for my reading and searching during the past months have revealed how little research material there is. At the outset I simply gave myself the task of reading all the Institute's journals. They are not complete. Of the twenty-eight issues of Landscape & Garden edited by the late Richard Smedley from 1934-1940 the Institute's library has only two. The Institute has been enormously assisted by its secretaries—Miss Wedford, Mrs. Brown and now Miss Dale, have assiduously filed correspondence. I have only read through some of the very early material but since a great deal will be confidential I have not asked authority of Council to do more. The chronology is therefore based almost entirely on information collected from the Journals. It may not be correct. It is very much my wish that the chronology be viewed and understood as no more than a reconnaissance, a check-list wanting verification from other sources.

Having said all that, are we forty years old this year or not? The first constitution states under Clause B (Election of Council) 'The Institute shall be deemed to have commenced its existence on 11 December 1929, and shall hold its opening Business Meeting on 28 January 1930.' It looks very much as though the decision taken to change the title from that of the British Association of Garden Architects was back dated from when it was in fact taken, viz. 28 January 1930, to 11 December 1929, when Thomas Mawson was elected president. Now since Mawson distinguished himself as a landscape architect one could presume that he either made the suggestion in the December meeting or later concurred with it. It is an important point but not a vital one. Enough to summarise by saying that creation was conceived—according to Quarterly Notes Number 1—by Stanley V. Hart in October 1928—that the title British Association of Garden Architects was chosen—that Hill, Jellicoe, Jenkins and Parker were co-opted and that by the end of 1929 or the beginning of 1930 the title changed to what it has been since that date, viz. Institute of Landscape Architects. No doubt in fighting between garden and building architects, the loss and argument of professional, went on for some time but what has been handed down is that only recently has landscape architecture emerged from its gardening connotations (some would claim that it still has not) but in at least that battle was over by the beginning. The description was not of course new. 'Landscape' had coined it, its use was extensive in the United States and Mawson used it in the country but though chosen as an early description of the Institute's professed claims, the garden design it treasure precise definition.

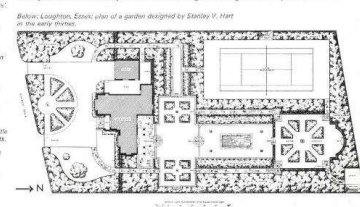

Baker, Loughlin, Essex plan of a garden designed by Stanley V. Hart in the early thirties.

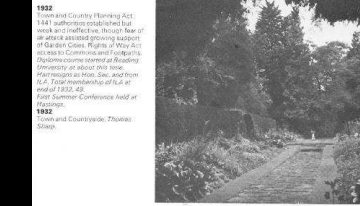

Lido Water Bungalow, Essex garden designed by Gilbert Jenkins

Institute of Landscape Architecture phase I was terminated by the outbreak of war. During those ten formative years a great deal was achieved: trends were won, people were influenced. A lecture described an occasion at the Royal Horticultural Society Hall. His lecture on Borough Gardens of Aylesbury was chaired by Sir Reginald Blomfield and the chief speaker was the Assistant Ambassador. As for Thomas Mawson, for the first president to be sixty-nine was good enough that the new profession was not another new-fangled notion of flippant youth. He had controlled a large practice of town planning and landscape architecture, was appointed the first university lecturer in that subject at the Liverpool Department of Civic Design in 1909 (the same university which made the first attempt, 1884, to establish architecture as an academic discipline). President of the Town Planning Institute from 1923-4 and in company with Blomfield and others a founder committee member of the Royal Fine Art Commission of 1924. Even education policy moved quickly. A. J. Cobb was a lecturer in horticulture at the University of Reading (charter 1929) and as Chairman of the Institute's Education Committee was instrumental in founding the three-year diploma course there in the very early thirties.

1933
Foundation of the Landscape Architecture at the AA, Glasgow
1934
Foundation of the Institute of Landscape Architecture at the AA, Glasgow

The Chelsea Flower Show can succeed or suffer the more alive of reality, one is blind and eighty-six. How remote comes?

many sources was Barry Parker, who alone prepared the site. Letchworth Garden City in ten City in 1923. Parker's Movement direct to Pugin, this country as the first and Jellicoe—co-opted influence. Parker was used to Read Refuse, Howard, 1908, Ltd., 1902. Letchworth, 1903, then he described the project is not merely an aim. It is an attempt to secure unity of value attached to land without pompous or to the study and advancement as a medium of freely. By comparison, the status of the Art of Landscape design, the promotion of a high standard of



'A cri de coeur for our children'
Margaret Stead, *Guardian*

The US
Bestseller

Last Child in the Woods

SAVING OUR CHILDREN FROM
NATURE-DEFICIT DISORDER

Richard
Louv

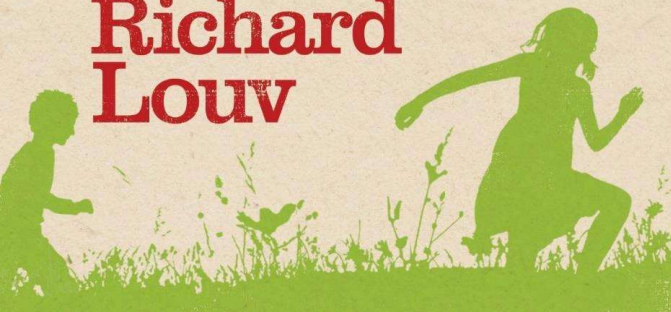

the NATURE FIX



*Why Nature Makes Us Happier,
Healthier, and More Creative*

FLORENCE WILLIAMS

500 Ways to Enrich the Health &
Happiness of Your Family & Community*
*and combat Nature-Deficit Disorder

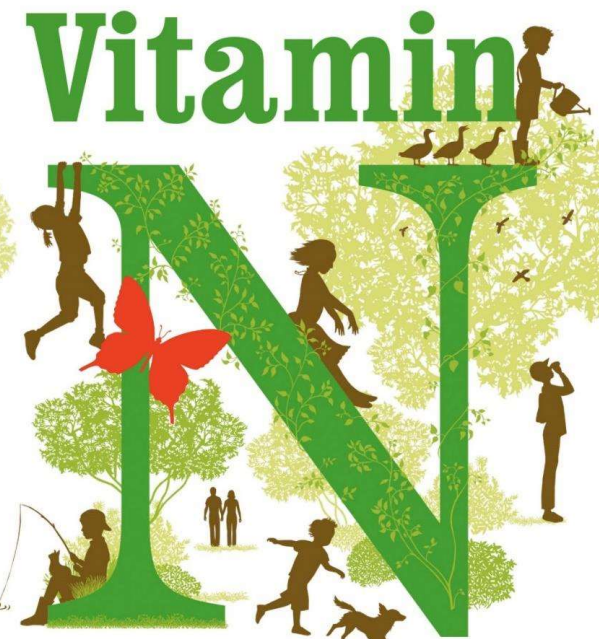

THE ESSENTIAL GUIDE TO
A NATURE-RICH LIFE

RICHARD LOUV



Duchess of Cambridge's forest-bathing garden for Chelsea Flower Show

Valentine Low, Harry Shukman

January 16 2019, 12:01am,
The Times

Gardening

Asia

Japan



Support The Guardian

Contribute →

Subscribe →

Search jobs Dating

Sign in Search

UK edition

The Guardian

News

Opinion

Sport

Culture

Lifestyle

More

Fashion Food Recipes Travel **Health & fitness** Women Men Love & sex Beauty Home & garden Money Cars

Shortcuts
Monarchy

Kate's forest bathing, Harry's meditating - wellness is a right royal fad

The Windsors are going all Gwyneth, building 'floating' yoga studios and giving up caffeine, and there is suggestion that it might be Meghan's influence



Hannah Jane Parkinson

@ladyhaja

Wed 16 Jan 2019 18:05 GMT



391 254



▲ Everything's gone green ... Kate, Harry, Meghan and Charles. Composite: Rex/Shutterstock/Press

Advertisement

Find your place today



The Guardian Jobs
Find good company